

Arteor™ Mirror plates for italian and US standard

Cat. No(s): 575 243/244/253/254/263/264/273/274/283/284/293/294
575 303/304/323/324/633/634/643/644/653/654/663/664/673/674
576 415/416/425/426/435/436/445/446/455/456/465/466
576 615/616/625/626/635/636/645/646/655/656/665/666/675/676/723/724/735/736

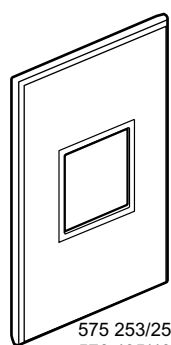

575 253/254
576 435/436

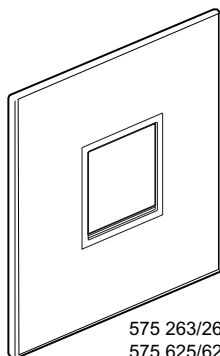

575 263/264
576 625/626

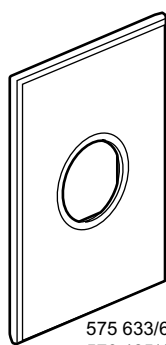

575 633/634
576 425/426

CONTENTS

Page

1. Use.....	1
2. Range.....	1-2
3. Overall dimensions.....	3
4. Mounting.....	3
5. Technical characteristics.....	3
6. Cleaning.....	3
7. Special use.....	3

1. USE

Plates for covering mechanisms.

2. RANGE

	Designation	Finishes				Number of modules	Fixing method	Weight (g)
		White	Black	Red	Taupe			
	1 module plate square (2" x 4")	575 244	575 243	576 416	576 415	1	With clips	130
	1 module plate square Vertical (2" x 4")	576 724	576 723	576 736	576 735	1	With clips	130
	2 modules plate square (2" x 4")	575 254	575 253	576 436	576 435	2	With clips	125
	2 modules plate square (4" x 4")	575 264	575 263	576 626	576 625	2	With clips	180
	2 modules plate round (2" x 4")	575 634	575 633	576 426	576 425	2	With clips	129
	2 modules plate round (4" x 4")	575 644	575 643	576 616	576 615	2	With clips	180
	3 modules plate square (2" x 4")	575 274	575 273	576 456	576 455	3	With clips	120
	3 modules plate square (4" x 4")	575 284	575 283	576 646	576 645	3	With clips	170

2. RANGE (suite)

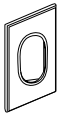
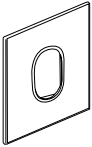
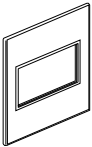
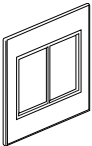
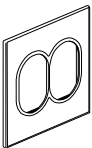
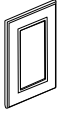
	Designation	Finishes				Number of modules	Fixing method	Weight (g)
		White	Black	Red	Taupe			
	3 modules plate round (2" x 4")	575 654	575 653	576 446	576 445	3	With clips	120
	3 modules plate round (4" x 4")	575 664	575 663	576 636	576 635	3	With clips	170
	4 modules plate square (4" x 4")	575 294	575 293	576 656	576 655	4	With clips	149
	2 x 3 modules plate square (4" x 4")	575 304	575 303	576 676	576 675	6	With clips	147
	2 x 3 modules plate round (4" x 4")	575 674	575 673	576 666	576 665	6	With clips	157
	Plate for 4 modules socket	575 324	575 323	576 466	576 465	4	With clips	141

Arteor™

Mirror plates for italian and US standard

Cat. No(s): 575 243/244/253/254/263/264/273/274/283/284/293/294
 575 303/304/323/324/633/634/643/644/653/654/663/664/673/674
 576 415/416/425/426/435/436/445/446/455/456/465/466
 576 615/616/625/626/635/636/645/646/655/656/665/666/675/676/723/724/735/736

3. OVERALL DIMENSIONS

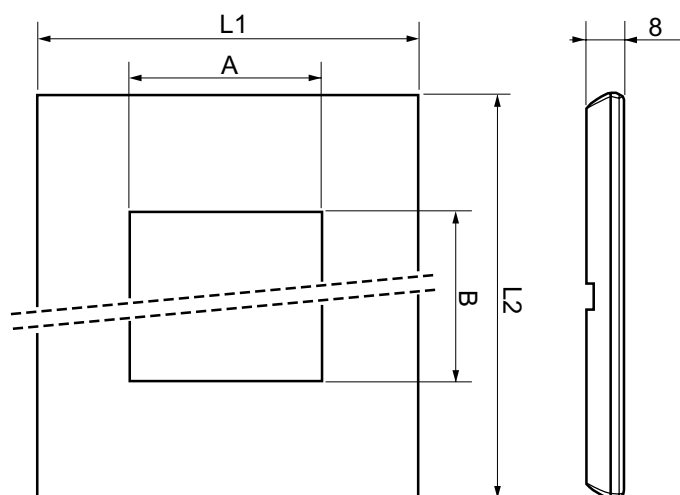

4. MOUNTING

The plates clip on in notches onto screw-type or claw-type mounting supports (notches are used for thickness compensation. E.g.: wall paper). Easy to remove with a screwdriver. No flatness defect of more than 1.5 mm in a periphery of 10 cm around the installed flush box. Protection film must be removed only once site work is fully completed.

5. TECHNICAL CHARACTERISTICS

5.1 Mechanical characteristics

Impact tests: IK 04

5.2 Material characteristics

Front plate: PMMA
 Under plate: polycarbonate
 Surround: chromed Zamac

5.3 Climatic characteristics

Storage temperatures: - 10° C to + 70° C
 Operating temperatures: - 5° C to + 50° C

6. CLEANING

Surface cleaning with a cloth. Do not use: acetone, tar remover, trichloroethylene.

6.1 Resistance to cleaning agents

Hexane (EN 60669-1), methylated spirits, soapy water, glass cleaning substance.

6.2 Resistance to hospital-type cleaning agents

Resistance to the following agents: Surfanios.

7. SPECIAL USE

Arteor plates must not be painted.

Cat. No.	L1	L2	A	B		
575 243/244	92	127	45.4	22.8		
575 253/254				45.4		
575 263/264	127			45.4		
575 273/274	92			68		
575 283/284	127			68		
575 293/294				90.6		
575 303/304	92		2 x 45.4	2 x 68		
575 323/324			45.4	90		
575 633/634	92		127	Ø 45.1		
575 643/644	127			Ø 45.1		
575 653/654	92	45.4		68		
575 663/664	127	2 x 45.4		2 x 68		
575 673/674		45.4		22.8		
576 415/416	92	Ø 45.1				
576 425/426		Ø 45.1				
576 435/436		45.4		45.4		
576 445/446				68		
576 455/456				90		
576 465/466		127		Ø 45.1		
576 615/616				Ø 45.1		
576 625/626				45.4		
576 635/636				45.4	68	
576 645/646					90.6	
576 655/656	127			2 x 45.4	2 x 68	
576 665/666		22.8				
576 675/676	92	45.4				
577 735/736		45.4				