

# 12-module Floor Boxes

Number(s) : 0 881 70/71/72

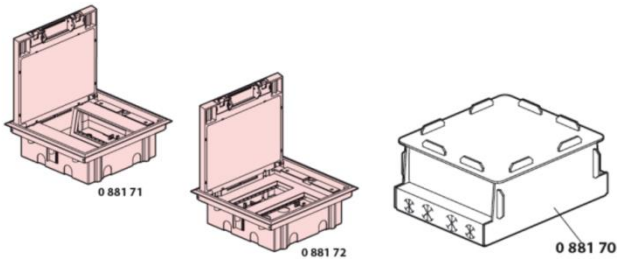

CONTENTS	Pages
1. Description	1
2. Dimensions	2
3. Installation	3 to 6
4. Installation specifics for IP24 perf.	7
5. Technical characteristics	8
6. Material characteristics	8

## 1. DESCRIPTION

12-module floor boxes allow :

- energy and data supply for working stations through the ground
- the use of various types of coatings like carpet or vinyl up to 8 mm high
- to supply their supports by ICTA sheath (20 mm Ø for both, 23 mm Ø and 25 mm Ø for horizontal mounting version)
- to ensure perfect cable separation
- the protection of the cords by a rigid cable exit.

They are also the ideal solution for concrete floor or technical floor for renovation, especially the vertical mounting version (from height 75 mm in raised floor and 80 mm in screed floor)

### 1.1 12-module Floor boxes range

Horizontal mounting  
Floor box

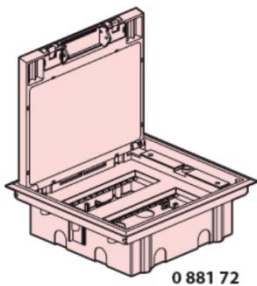

Vertical mounting  
Floor box

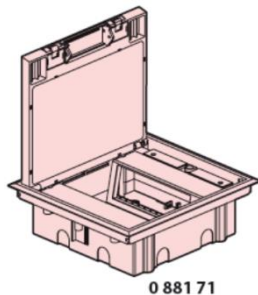

Adjustable height from 75 mm to 110 mm.  
To be equipped with 12 Mosaic / Arteur / Myrius Modules wiring 12-module ories.  
Delivered with movable lid with 8 mm recess for carpet or vinyl.  
Easy opening by large handle  
Certified to IEC 60670-1 and IEC 60670-23 standard  
Grey color ral 7031

## 1. DESCRIPTION (CONT.)

Lid removing : can be removed for an easy installation of socket ...

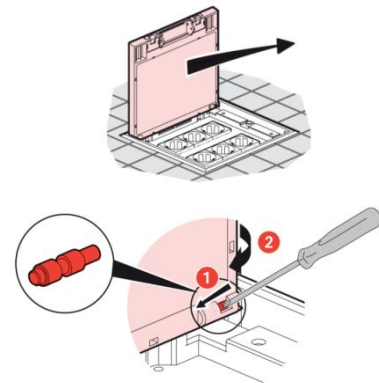

... and can be turned at 180° in order to change the cable exit orientation.

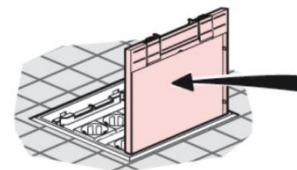
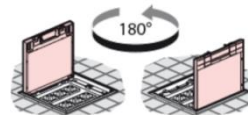

### 1.2. Backbox

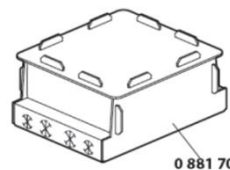

Material : Polypropylène alveolar

This under-floor backbox for concrete floor allows pouring the concrete over ICTA flexible conduits before installing floor boxes.  
The backbox is flat packed and has to be folded during installation.

## 2. DIMENSIONS

### 2.1 12-module floor boxes nr 0 881 71/72

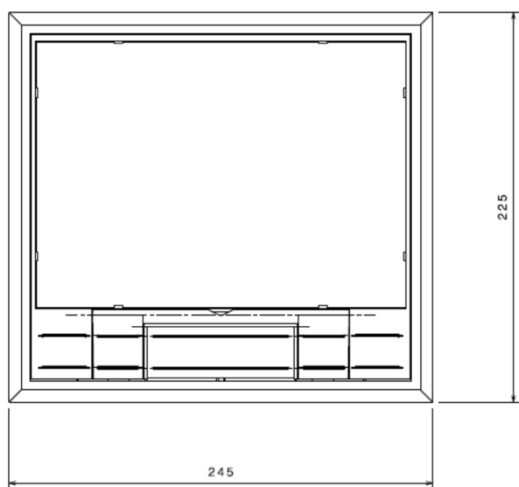
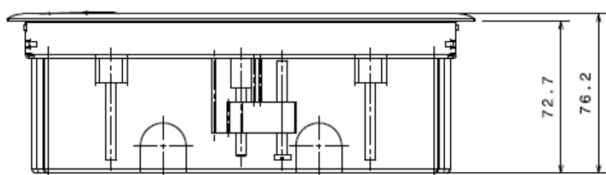

8 mm recess

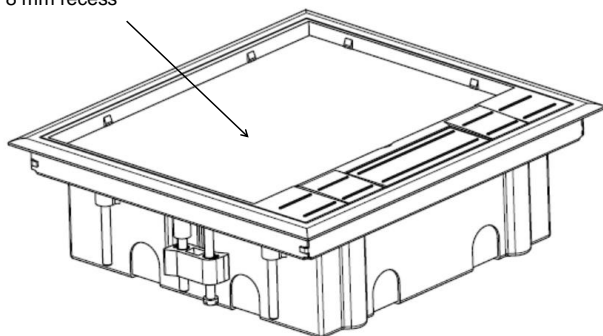

## 2. DIMENSIONS(CONT.)

### 2.2 Backbox nr 0 881 70

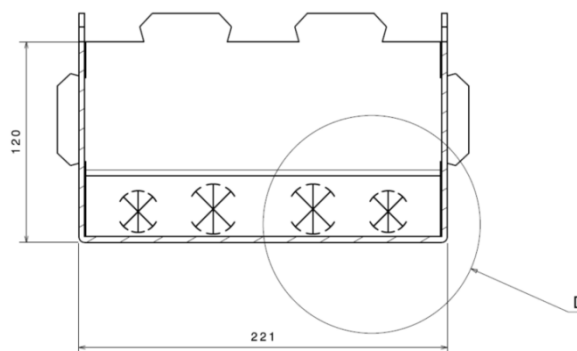
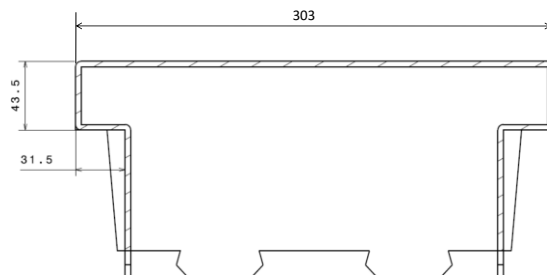
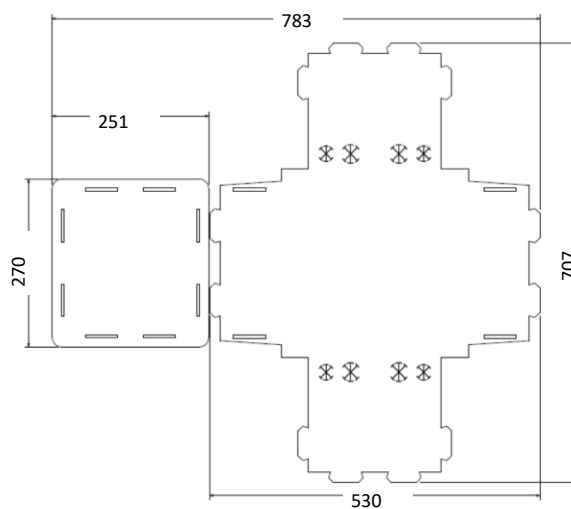

D

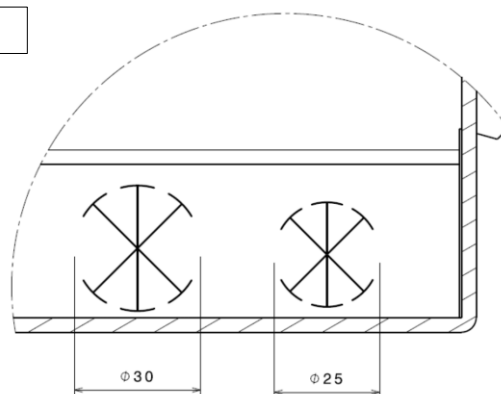

## 3. INSTALLATION

### 3.1 On technical floor

Cut the technical floor

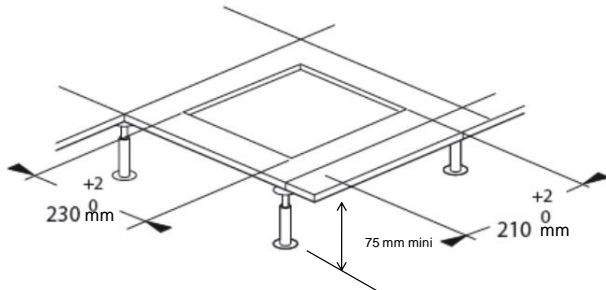

Measure the depth H of the floor

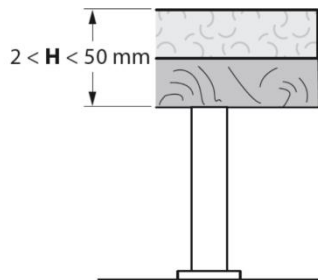

Screw A and B in order to have  $H + 5 \text{ mm mini}$  between the base of the lid and the end of the screw B

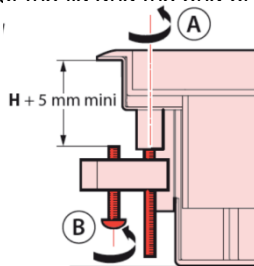

Put the fixing brackets on each side along the box (sharp extremity towards the box).

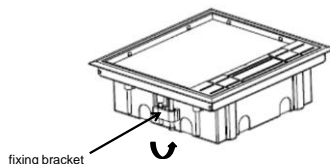

Then put the floor box into the technical floor and screw C in order to fix it. Minimum height required is 75 mm.

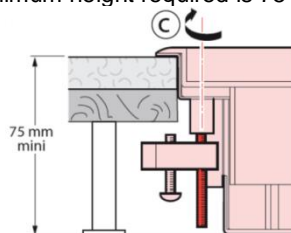

## 3. INSTALLATION(CONT.)

Wiring devices installation

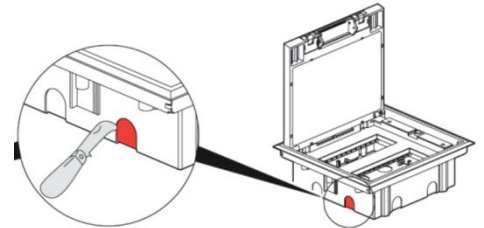

remove the side cap from the insulator in order to pass the cables or conduits

### 3.1.1 Horizontal mounting number 0 881 72

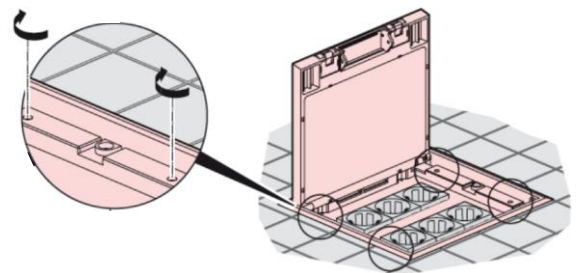
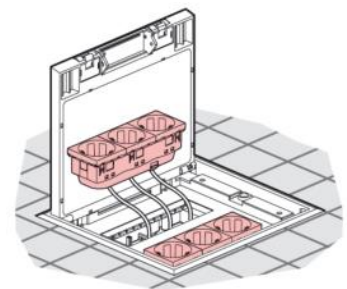

Adjust the height of wiring devices support by screwing the 4 screws



$X < 110 \text{ mm}$



$X = 110 \text{ mm}$

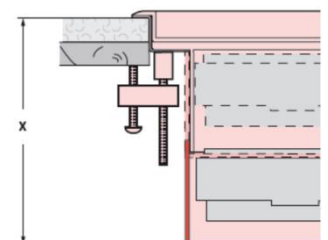

## 3. INSTALLATION

### 3.1.2 Vertical mounting number 0 881 71

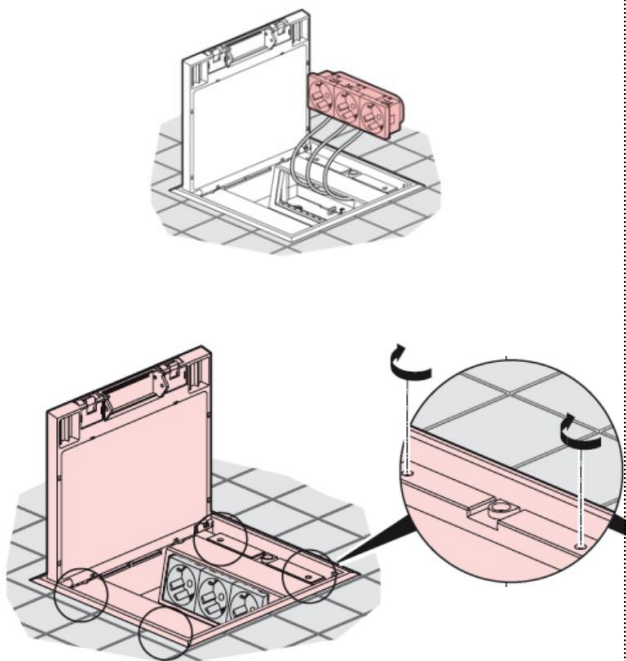

Adjust the height of wiring devices support by screwing the 4 screws

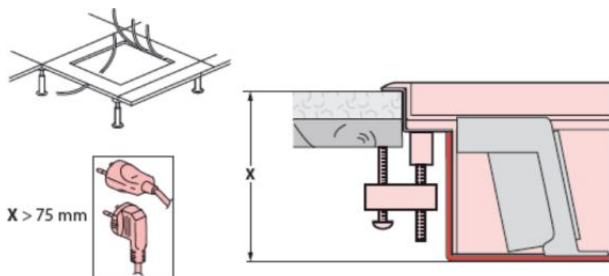

## 3. INSTALLATION (CONT.)

### 3.2 In concrete with backbox nr 0 881 70

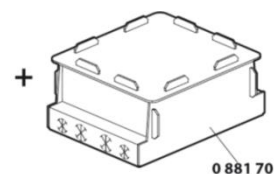
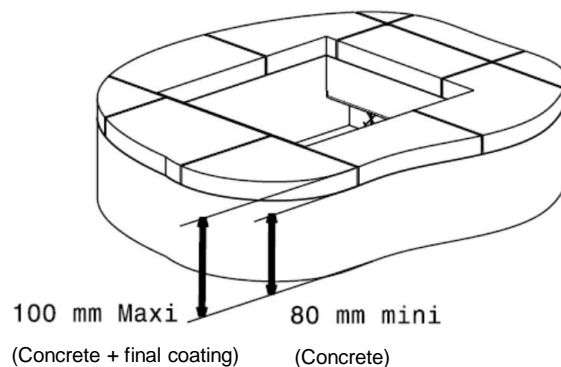

- Bend the backbox

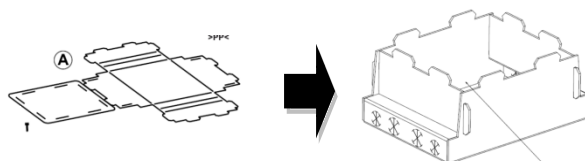

- Fix the backbox on the slab

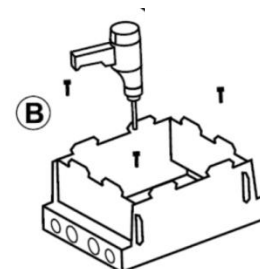

- Put the flexible conduits (use a tool to fold)

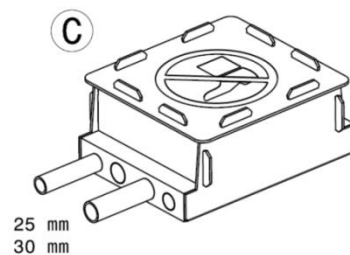

Do not cross

## 3. INSTALLATION (CONT.)

- Pour the concrete : 80 mm mini

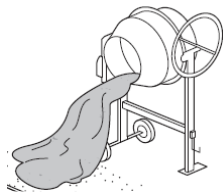

**!** (and keeping well in mind the 100 mm maxi with the final coating included)

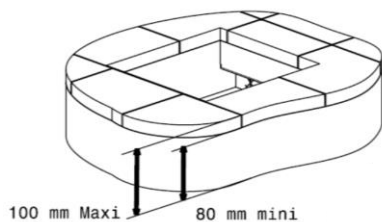

Cut once concrete is dry

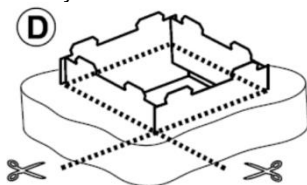

Remove the screws (A) of the 2 fixing brackets on each side of the box and put the floor box into the concrete floor and screw © in order to fix the floor box

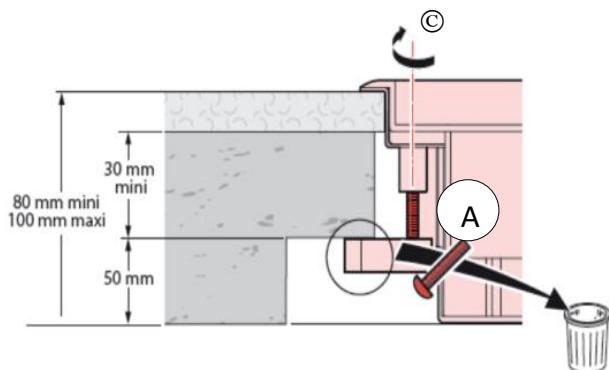

## 3. INSTALLATION (CONT.)

Wiring devices installation

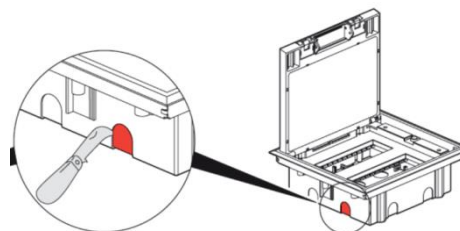

remove the side cap from the insulator in order to pass the cables or conduits

### 3.2.1 Horizontal mounting number 0 881 72

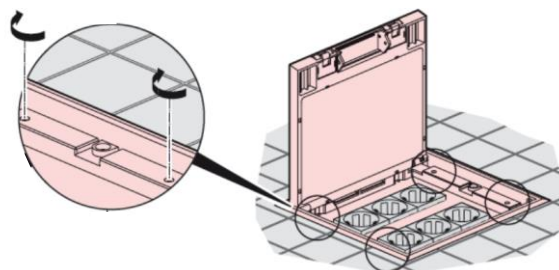
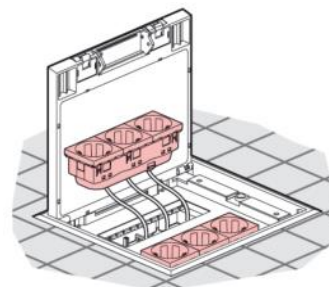

Adjust the height of wiring devices support by screwing the 4 screws

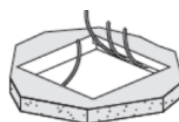

X > 90 mm

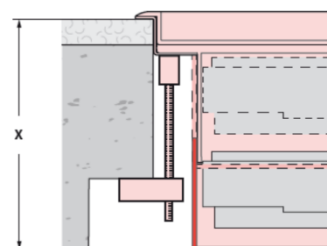



## 3. INSTALLATION (CONT.)

### 3.2.2 Vertical mounting number 0 881 71

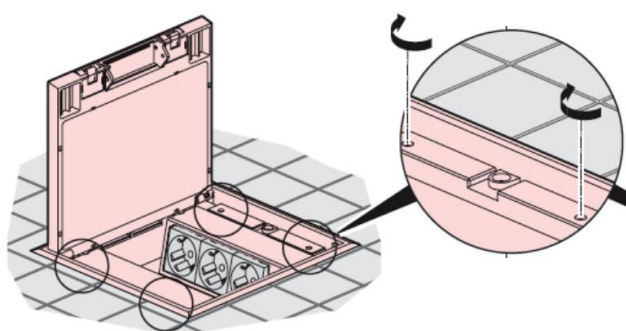
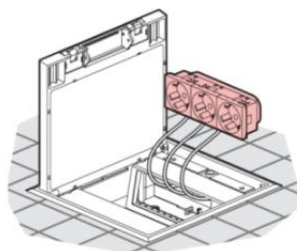

Adjust the height of wiring devices support by screwing the 4 screws

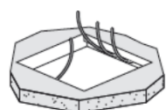

X > 80 mm

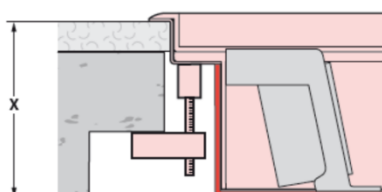
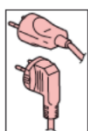

## 3. INSTALLATION (CONT.)

Finishing plates

Lid is equipped with a metal plate allowing its rigidity. Don't use tile on lid but carpet or vinyl up to 8 mm high

Cut the carpet or vinyl according to the dimensions below :

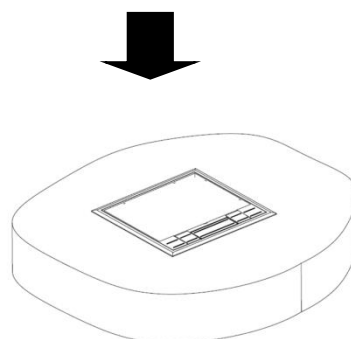
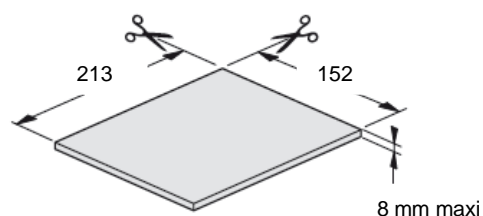

## 4. INSTALLATION SPECIFICS FOR IP24 PERFORMANCE

For IP24 performance of the wiring devices supports

### 4.1 In screed floor for both two floor boxes (nr 0 881 71/72)

Provide an evacuation drain before pouring the concrete screed.

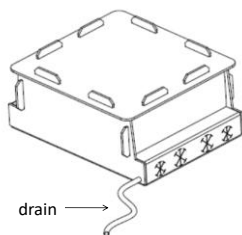

### 4.2 For horizontal mounting supports floor box (nr 0 881 72) in any kind of floor

Before installing the floor box into the floor, create a minimum 4 degrees slope towards the cable exit : lower this side of 11 mm compared to the other side by acting on the 2 screws of the drawing below

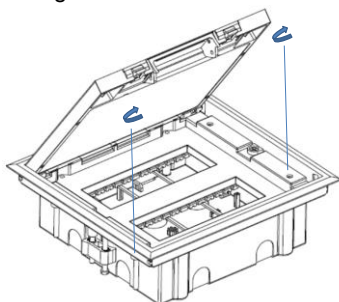

The minimum depth required in the floor then becomes 83 mm (final coating included)

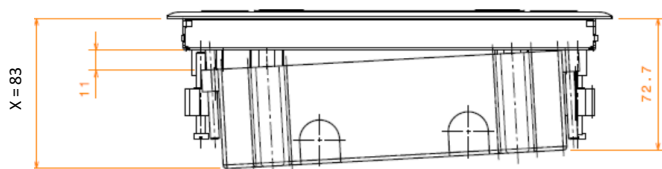

X : minimum final floor height required

## 4. INSTALLATION SPECIFICS FOR IP24 PERFORMANCE

The compatibility with the user types of plugs becomes

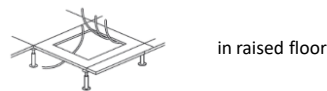

$83 < X < 110$  mm



$X = 110$  mm



X 2 max  
(cable exit side)

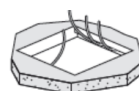
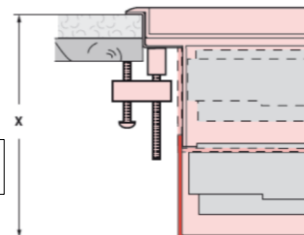

in screed floor

$X > 101$  mm

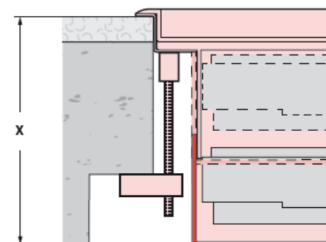

## 5. TECHNICAL CHARACTERISTICS

Classification of the 12-module Floor boxes according to the IEC 60670-1 et IEC 60670-23 standard :

7.1 The nature of their material	Composite
7.2 The method of installation	Flush, semi-flush or embedded in non-combustible floors Placement suitable for installation into concrete during the casting process Floor boxes or enclosures installed in floor subjected to dry treatment
7.3 The type of inlets (outlets)	Without inlets. Inlet openings will be made during installation
7.4 The clamping means	Without clamping means
7.5 The minimum and maximum temperatures during installation	-5°C to +60°C
7.6 The maximum temperature during the casting process	+60°C
13 Protection against ingress of solid objects & against harmful ingress of water	IP 20
15.101 Resistance to vertical load through a small surface	500 N

### Protection class :

Protection to **IP20** with the cover closed (possible up to IP24 : see paragraph "Installation specifics for IP24 performance")

Resistance to impacts **IK 08** with the cover closed

Self-extinguishing : + 650° C / 30 s for parts made of insulating materials

The inlets of conduits or cables are pre-cutting for a easier installation

### Safety :

Check that the system is earthed

### Cleaning :

Do not use abrasive products or detergents

## 6. MATERIAL CHARACTERISTICS

The Floor box is :

- \* Plastic materials : ABS
- \* Galvanised steel ( Z140 )
- \* Galvanised steel ( Z275 )

The backbox is :

- \* Plastic materials : PP alveolar